

instructions

TBC-750LS



4270 Airborn Drive
Addison, TX 75001
tel: +1 (972) 248-1999
email: info@STARTinternational.com
www.STARTinternational.com

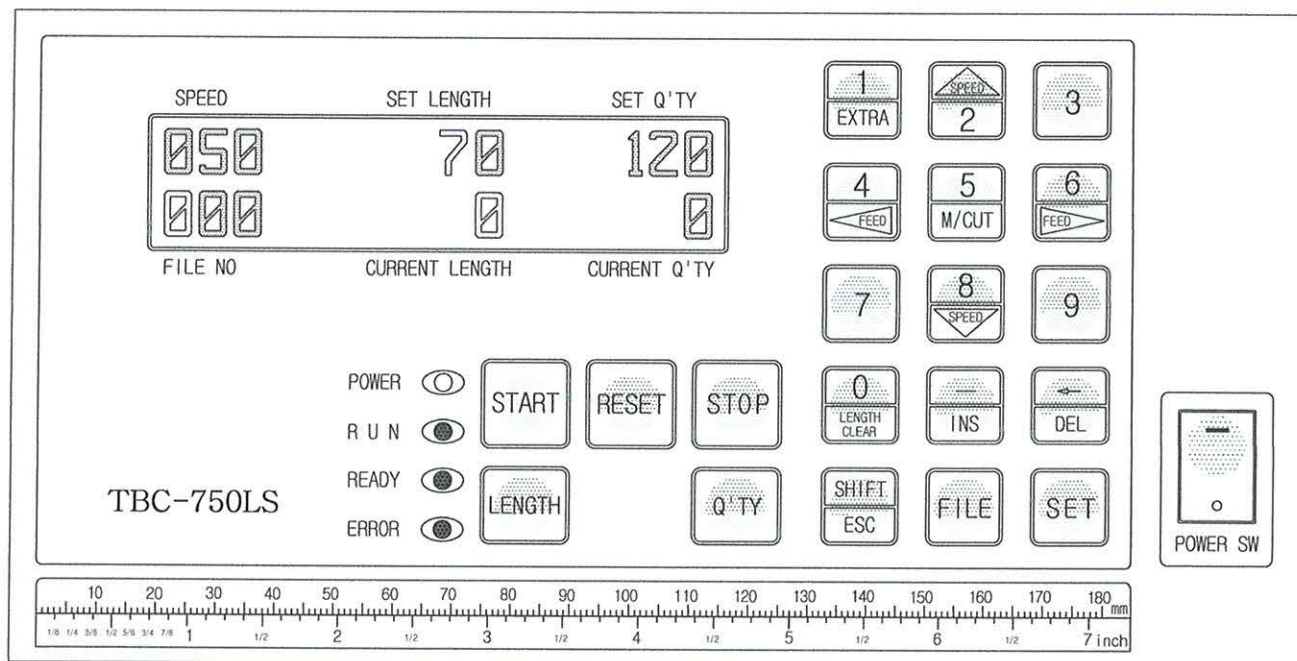

START[®]
International

How to operate TBC-750LS

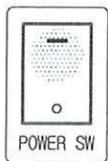

1. An example (Cutting length : 70mm, Cutting quantity : 120 pcs)

▷ Turn on the POWER SW.



▷ Set cutting length. (Press the following buttons in order.)

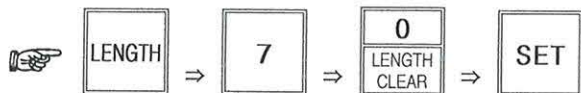

▷ Set cutting quantity.

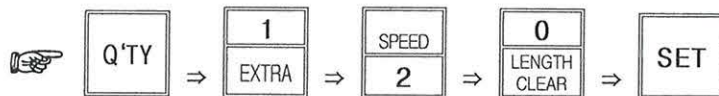

▷ Press START button.



How to use sensor KRTG-20

- ① Mount the sensor on the guide-rail and connect the jack of sensor into the connector of machine downside.

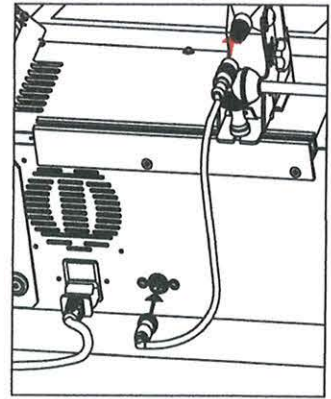

- ★② Locate the cutting line of label on the lower knife blade precisely & move the sensor close to the knife.
(This step is essential just before fix the location of sensor.)

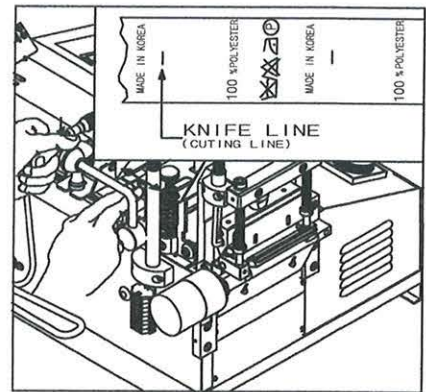

- ③ Adjust the sensor with guide-control bolt for lightening the beam on the center of marking point.

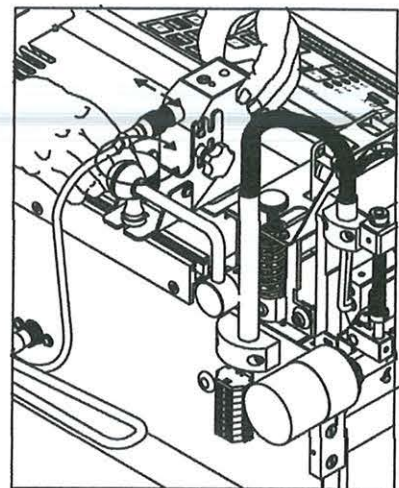

★④ Position the light spot on the background of label

and make status indicator Q/T blinking quickly.

Lamp "Delay" & "L/D" will blink too.

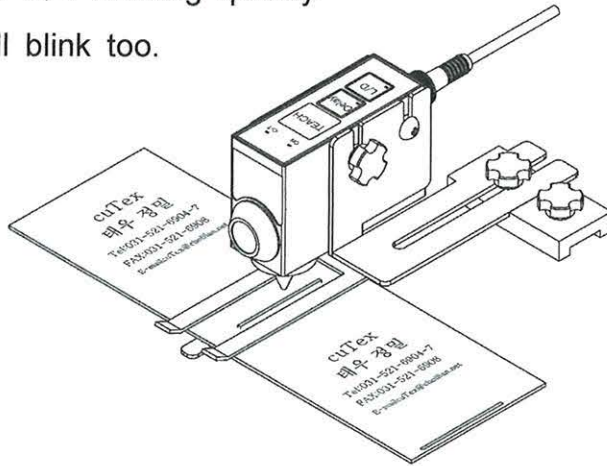
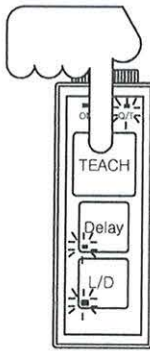

⑤ Move the light spot to the mark(cutting line or figure, letters)

and when you press TEACH button, lamp delay,

L/D will be off and Q/T will stop blinking.

(This time, if Q/T continues to blink quickly, the contrast is insufficient, Set it again.)

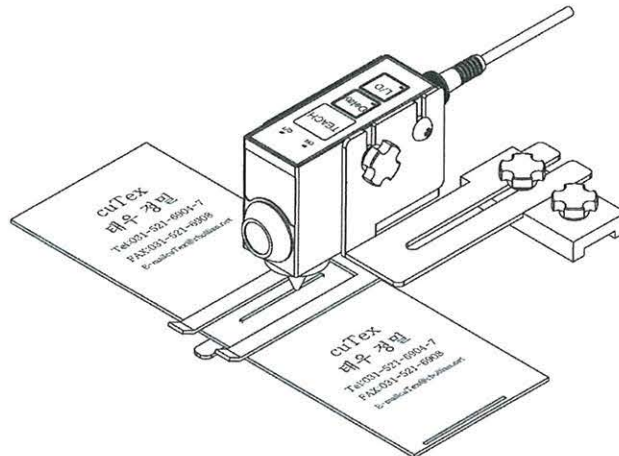
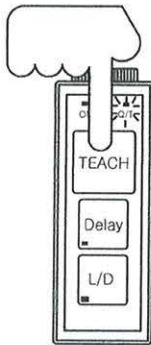

(Caution)

- ※ Whatever the background is darker or lighter than the mark, activate TEACH the background first and the mark second.
- ※ After setting the sensor, do not press Delay, L/D button, it may happen an error changing input data.

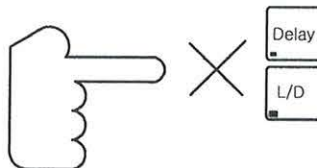

- ※ In the case of objects with reflective or shiny surface, tilt sensor by 10° to 15° relative to surface.

2. Key functions



: Current length on display will be back to "0" at a stop.



: All of current length and current q'ty on display will be back to "0".



: Moving knife only.

- ① to cut the material for test.
- ② to take out the material jammed between knife blades.
- ③ for balancing of knife blades in exchange.



: Cutting additional one.



: Restoring to normal condition in ERROR(red LED) and inputting parameter or program.



: to move the roller manually for mounting the material on the machine or for feeding it forwards or backwards.



– Speed up (The current speed appears on the left-upside of LCD display with "%". Normal speed : 50%, Maximum speed : 100%)



– Speed up (The current speed appears on the left-upside of LCD display with "%". Normal speed : 50%, Maximum speed : 0%)

* Speed up & down is possible in any time(operation or stop) and set-speed will not be changed even though you press RESET button or power off & on.



: to correct wrong data.



: Function for label cutting (applicable models : TBC-50S, TBC-50SH)

3. Specification

Model No.	Cutting Material	Knife	Power Supply	Max. Cutting Width	Range of Cutting Length	Cutting Speed (Length : 1M)
TBC-750LS	extra large material	Cold	AC110 /220V, 50/60Hz	500mm	1mm~300M	17~28 cuts

4. Caution for use

- Before use, please confirm the voltage and make the ground(earth) connection.
- In case of cutting double or triple rolls at the same time, make materials fed oppositely(↶ & ↷), to prevent slipping by roll tension.
- Do not access hands or any object close to the working knife. (for safety)
- When the knife blade becomes dull, please use it after grinding with the grinding machine. (Please do not let the unskilled person grind manually or install the knife blade.)

TBC-750LS Part Drawing A (Cutting Part)

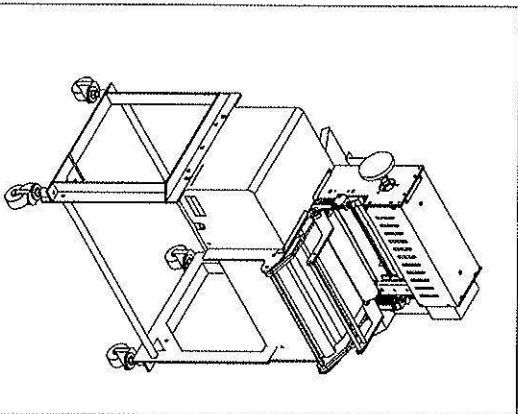
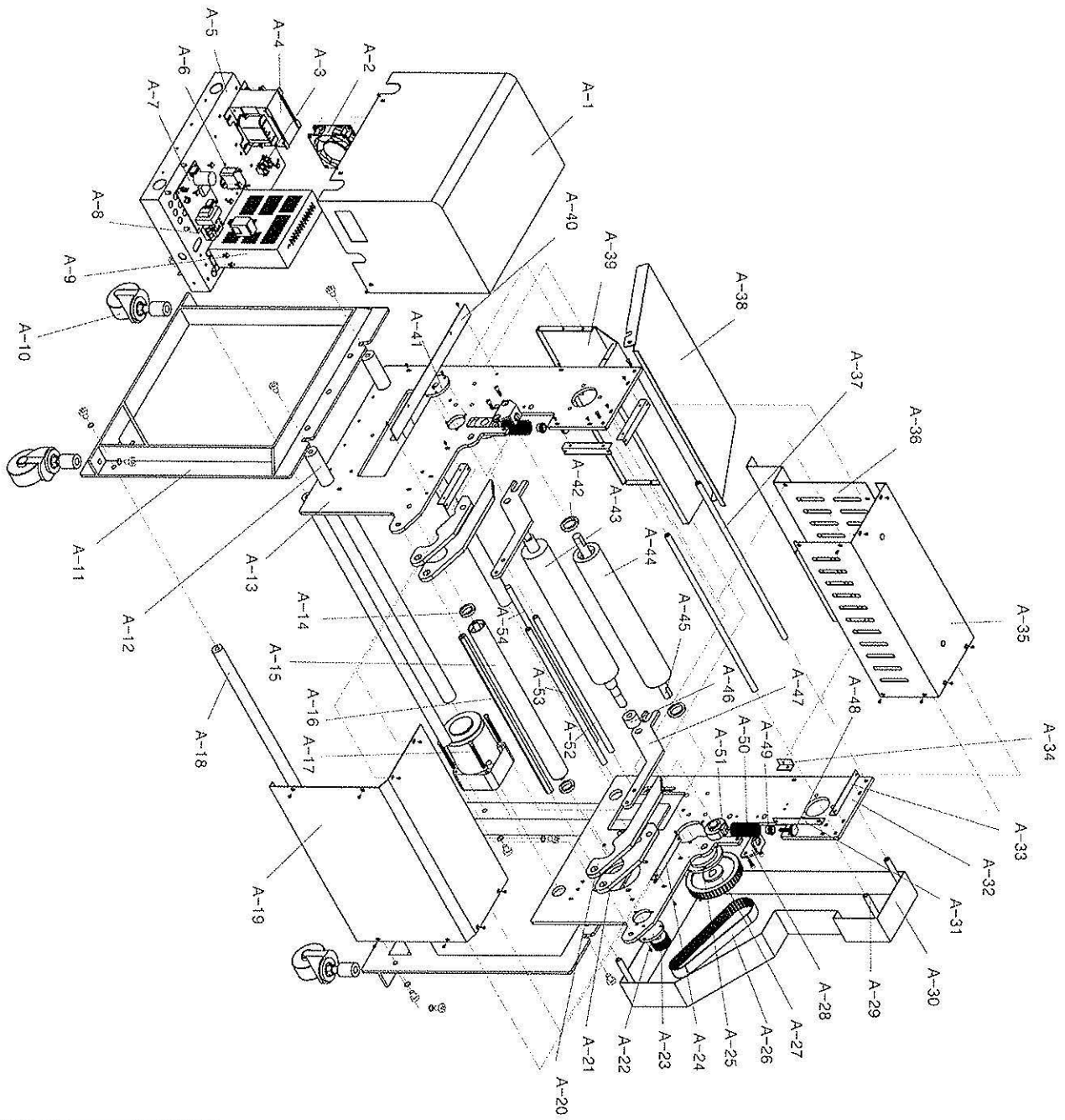

TBC-750LS Part List A (Cutting Part)

Part No.	Description	Part No.	Description
A-1	CONTROL CASE	A-28	ROLLER TENSION BRACKET
A-2	FAN	A-29	SAFETY COVER SUPPORT
A-3	TERMINAL	A-30	SAFETY COVER
A-4	TRANSFORMER	A-31	ANGLE NUT
A-5	CONTROL BASE	A-32	LEFT FRAME
A-6	CONDENSER	A-33	ANGLE NUT
A-7	DR BOARD	A-34	ANGLE NUT
A-8	RELAY	A-35	UPSIDE COVER
A-9	DRIVER BOARD	A-36	FRONT COVER
A-10	CASTER	A-37	SUPPORT
A-11	ANGLE FRAME	A-38	MATERIAL GUIDE
A-12	ANGLE SHAFT	A-39	REAR COVER
A-13	RIGHT FRAME	A-40	ANGLE NUT FOR FIXING CONTROL COVER
A-14	BEARING	A-41	ROLLER BEARING HOUSING (RIGHT)
A-15	GUIDE ROLLER	A-42	BEARING
A-16	REAR GUIDE SEXANGLE SHAFT	A-43	LOWER ROLLER
A-17	MOTOR	A-44	UPPER ROLLER
A-18	ANGLE SHAFT	A-45	UPPER ROLLER SHAFT
A-19	FRONT COVER	A-46	FIXING RING
A-20	REAR GUIDE	A-47	LEVER

TBC-750LS Part Drawing B (Feeding Part)

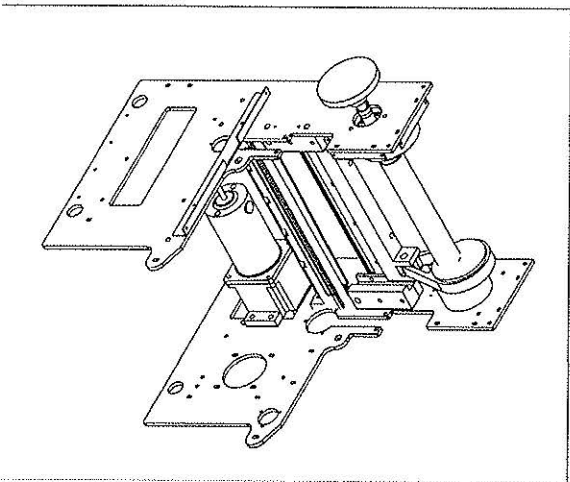
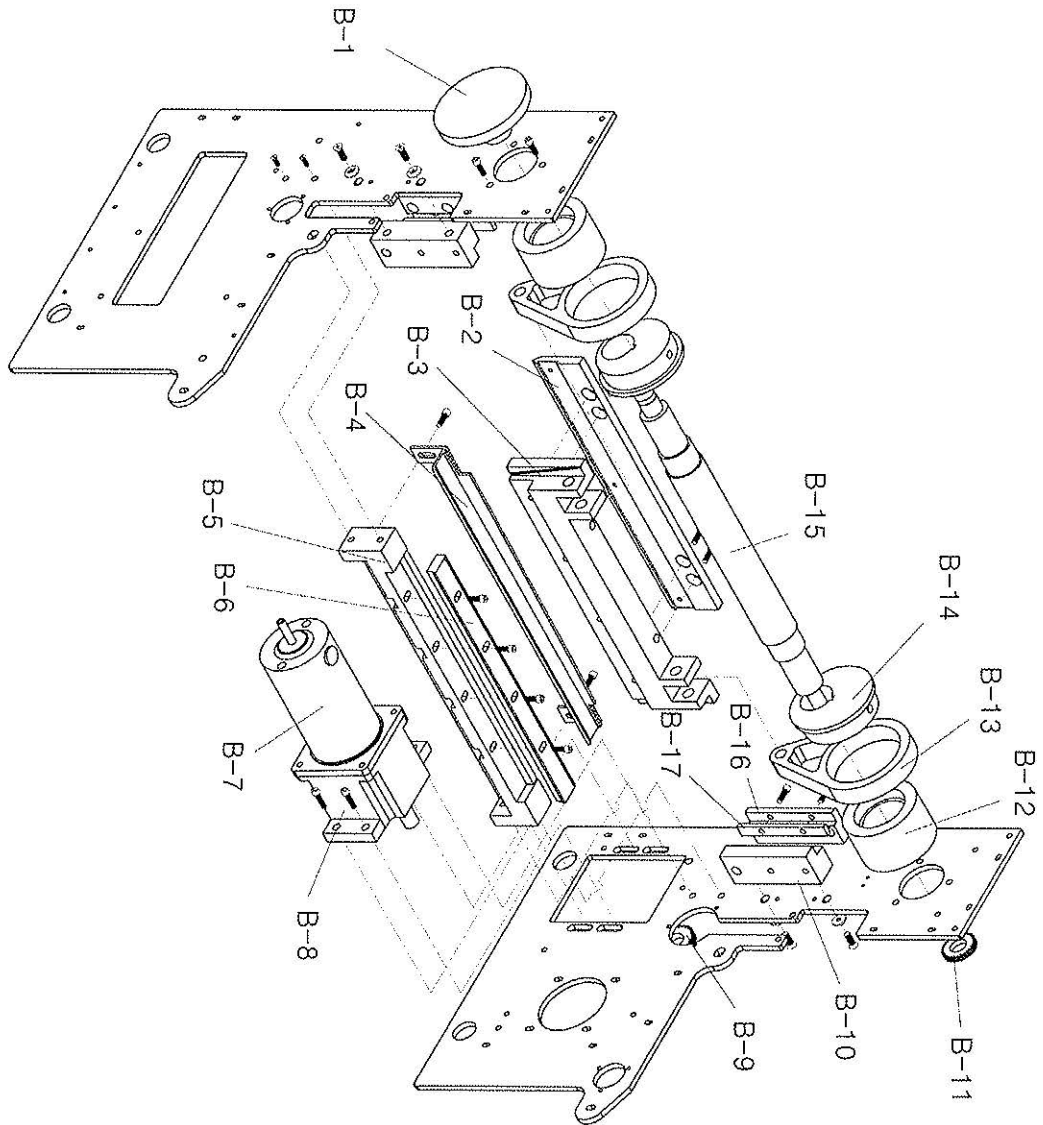

TBC-750LS Part List B (Feeding Part)

Part No.	Description	Part No.	Description
B-1	SHAFT KNOB HANDLE		
B-2	UPPER KNIFE		
B-3	UPPER KNIFE FRAME		
B-4	STOPPER		
B-5	LOWER KNIFE BRACKET		
B-6	LOWER KNIFE		
B-7	MOTOR		
B-8	REDUCTION GEAR		
B-9	GEAR		
B-10	PRESSURE PLATE (PAD)		
B-11	GEAR		
B-12	CRANK BEARING HOUSING		
B-13	LINK		
B-14	CRANK		
B-15	CRANK SHAFT		
B-16	PRESSURE PLATE		
B-17	PRESSURE PLATE (PAD)		

Trouble-shooting of TBC-50 series

No	Troubles		Applicable model	Causes & Measures
1	No power supply		All models	<ul style="list-style-type: none"> - Check if electric cord is connected well. - Check if the fuse blows out or not.
2	Power is on, but no work	Feeding roller doesn't work.	All models	<ul style="list-style-type: none"> - Check if there is inserted any alien substance in roller. - If current length on display is changed, exchange drive board. - If current length on display is not changed, exchange Control board(MB).
		Knife doesn't work.	All models	<ul style="list-style-type: none"> - Check if pressure plates of upper knife are too much fastened or not.
		LCD display doesn't work.	All models	<ul style="list-style-type: none"> - After opening the cover, check the connection. (especially between Operation & MB board)
		All functions don't work	All models	<ul style="list-style-type: none"> - Check if auto-stop device lies down. If any, raise it up.
3	Material is not cut.		Hot cutter (H, LH, SH, HX)	<ul style="list-style-type: none"> - Check if temperature goes up to set-degree. - Check if knife blades are even(parallel).
4	Material is cut onesidedly.		All models	<ul style="list-style-type: none"> - Check if blades are damaged or weared. - After making both knives close each other by M/CUT button and check if they are even or not. (If they are not even, adjust them by bolts)
5	Cut-length is different from set-length.		All models	<ul style="list-style-type: none"> - Test cutting after loosening material from the reel by hand or attaching feeding device.
6	It cuts before the cutting line of labels.		Label cutter (S, SH)	<ul style="list-style-type: none"> - Move the sensor towards knife side as long as the difference by pushing.
7	It cuts after the cutting line of labels.		Label cutter (S, SH)	<ul style="list-style-type: none"> - Move the sensor towards counter-knife side as long as the difference by pushing.
8	ERROR on LCD & LED	ERROR CODE [064] >Sensor check Er	Label cutter (S, SH)	<ul style="list-style-type: none"> - Trouble in Mark sensor → · Check if the sensor is connected well or not. · Check if the sensor is adjusted well or not. (FILE NO 001) · Check if it is label problem or not.
		ERROR CODE [065] >CUT I/O Error!	All models	<ul style="list-style-type: none"> - Trouble in cutting motor or cutting sensor → · Upper knife moves 1~3 sec. and ERROR on display. Check the connection of cutting sensor. If not, exchange the cutting sensor. · Upper knife doesn't move and ERROR on display. Exchange the cutting motor or drive board.
		STOP INPUT !! CHECK STOP INP!	All models	<ul style="list-style-type: none"> - Auto stop device is pressed down or shortage. → raise up the device and check shortage.
		(C)ACORD CTRL-OP AMC-T3KA VER1.7D	All models	<ul style="list-style-type: none"> - Bad connected ROM → Press ROM by hand or connect it again. (If not, change MB board)
		ERROR CODE[065] >CHECK CODE[003]	All models	<ul style="list-style-type: none"> - Change of FILE 003 in program by noise or mis-operation → Initialize the controller. ※ How to Initialize(programs to be initial) : press SET+SHIFT/ESC buttons and RESET button at the same time. (Press RESET later than other two keys.)
9	Operator feels electric current in touch of machine.		All models	<ul style="list-style-type: none"> - Connect the earth cord(green) to any bolt of backside of machine.
10	After exchange ROM, you should do initialize the controller , due to error message, if you cannot do initialization, please press "SHIFT/ESC" button to escape error message screen and then initialize the controller .			



START[®]

I n t e r n a t i o n a l

Taping & Labeling Solutions

**4270 Airborn Drive
Addison, TX 75001 USA**

tel. +1 (972) 248-1999

fax. +1 (972) 248-1991

email: info@STARTinternational.com

www.STARTinternational.com

**Please do not disassemble/modify machine or its part without permission.
If you disassemble/modify machine or its parts, you cannot receive warranty/after-sales service.**